

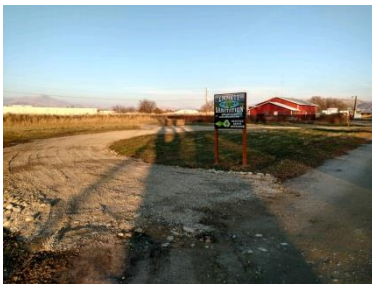

**Emmett Sanitation Recycle Depot**  
**2200 S Boise Ave**  
**Emmett, ID 83617**

- The recycle depot sits on the front portion of Emmett Sanitation's property, to the east side of our gated facility. You enter the depot loop to the left - just off South Boise Avenue. The depot is open to residents of both Gem County and the City of Emmett. **Please do not enter the fenced operations yard area.**



- Emmett Sanitation limits the material accepted to **Cardboard and Aluminum only**. We may expand the program in the future depending on overall participation and the ability to find sustainable markets for the material.

- The depot is open **Monday - Friday from 8am - 5pm**. As we monitor the depot's usage over time, we may modify those hours in case of emergency and depending on overall activity.

- Please keep the recycle depot open and free to the public by observing the guidelines.

- Please break down cardboard and smash aluminum cans prior to dumping them in the appropriate bins (your cooperation is greatly appreciated).

**-IF THE BINS ARE FULL, DO NOT DUMP YOUR MATERIAL.** Allow Emmett Sanitation an opportunity to empty the containers first, you are welcome to make another attempt when the bins have adequate space.

**- PLEASE, NO trash, furniture, electronics waste, paint cans, motor oil, batteries, household hazardous waste or other illegal dumping allowed.** The recycle depot is monitored 24 hours a day by surveillance camera.



- Customer Care -  
**208.365.6103**

[www.idwaste.com](http://www.idwaste.com)